

PROJECT

A40 SMART CORRIDOR

PROJECT NUMBER

60615257

CLIENT



County Hall, New Road
 Oxford, OX1 1ND
 Tel: 01865 792422
 www.oxfordshire.gov.uk

CONSULTANT

AECOM I&E Ltd.
 AECOM House, 63-77 Victoria Street
 St Albans, Herts AL1 3ER
 Tel: 01727 535000
 www.aecom.com

NOTES

- DRAWING IS BASED ON TOPOGRAPHICAL SURVEY SUPPLIED BY AMEC FOSTER WHEELER (AFW) AND WAS LATER ENRICHED BY ADDITIONAL TOPOGRAPHICAL INFORMATION.
- ITEMS IN GREY (APART FROM SOLID HATCHING) REPRESENT EXISTING INFRASTRUCTURE.
- REFER TO DRAWING BUS-ACM-HDG-E2_ZZ_ZZ_ZZ-DR-CH-0501-0522 ISSUED TO OCC ON 25/06/2021 FOR FURTHER INFORMATION ON THE PROPOSED DRAINAGE.
- REFER TO DRAWING A40SUB-ACM-HFD-A40_SW_ZZ_ZZ-DR-CH-0005 ISSUED TO OCC ON 28/07/2020 FOR FURTHER INFORMATION ON THE PROPOSED SUBWAY.
- ALL CONTROLLED CROSSINGS WILL BE EITHER RAISED, COLOURED / SURFACE DIFFERENTIATED.
- CONSIDERATION TO BE GIVEN TO SHARED PATH SURFACING TYPE.
- CYCLE STORAGE TO BE PROVIDED AT BUS STOPS.
- FOR DUALLING SECTION OVERVIEW, REFER TO DRAWING DUAL-ACM-HGA-E1_ZZ_ZZ_ZZ-DR-CH-0608.
- FOR DUKE'S CUT SECTION OVERVIEW, REFER TO DRAWING DUKE-ACM-HGA-E3_ZZ_ZZ_ZZ-DR-CH-0104.

ISSUE/REVISION

I/R	DATE	DESCRIPTION
P03	08/07/21	CLIENT COMMENTS
P02	02/07/21	POST-CONSULTATION UPDATES
P01	29/06/21	INITIAL ISSUE

KEY PLAN

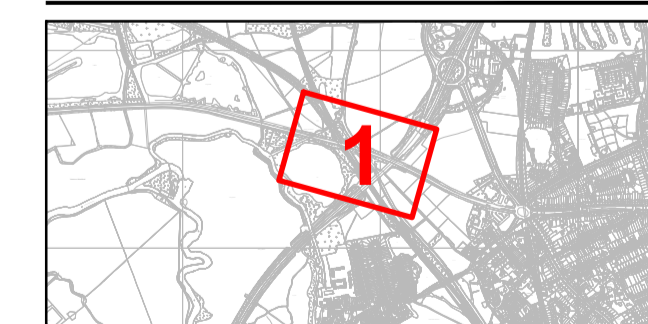

SHEET TITLE

DUKES CUT CABINET MEETING OVERVIEW #1

SHEET NUMBER

Project Number	Originator	Volume	Revision
DUKE - ACM - HGA			P03
E3_ZZ_ZZ_ZZ	-DR-CH-0104		
Location	I Type	I Role	I Number

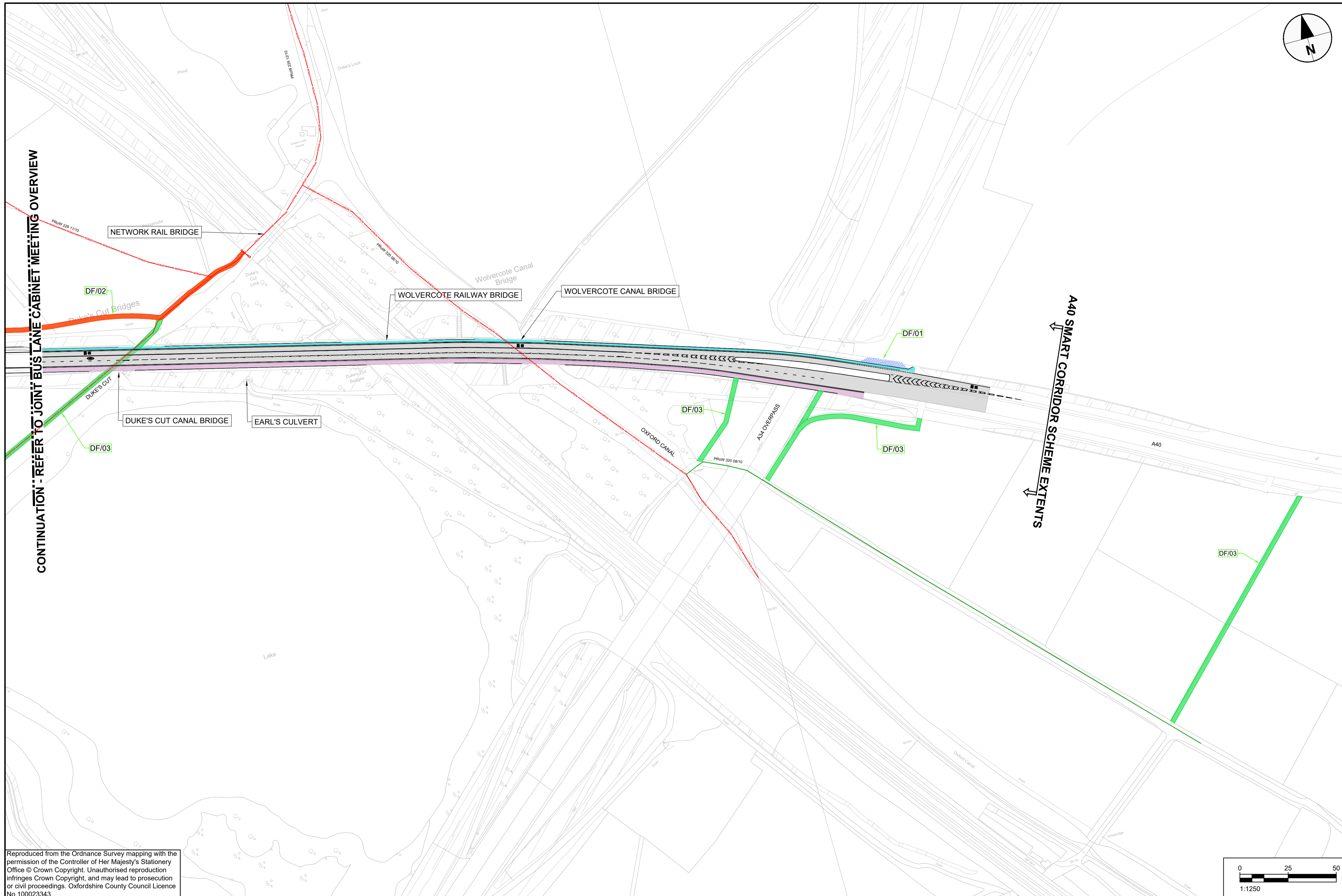

Reproduced from the Ordnance Survey mapping with the permission of the Controller of Her Majesty's Stationery Office © Crown Copyright. Unauthorised reproduction infringes Crown Copyright, and may lead to prosecution or civil proceedings. Oxfordshire County Council Licence No 100023343.

KEY	
	EXISTING STRUCTURE - SCALE VARIES
	PROPOSED BUS STOP
	PROPOSED ROAD MARKINGS. DETAILS TBC
	PROPOSED KERB. DETAILS TBC
	EXISTING PUBLIC RIGHT OF WAY - BRIDLEWAY
	EXISTING PUBLIC RIGHT OF WAY - FOOTWAY
	PROPOSED SHARED USE FACILITY
	PROPOSED FOOTWAY
	PROPOSED TRAFFIC ISLAND (HARD SURFACE). DETAILS TBC
	PROPOSED BUFF TACTILE PAVING
	PROPOSED RED TACTILE PAVING
	NCNS LINK ROUTE - NORTHERN OPTION
	NCNS LINK ROUTE - SOUTHERN OPTIONS
	PROPOSED VEHICLE CROSS OVER
	PROPOSED VEHICLE MAINTENANCE LAY-BY. DETAILS TBC
	PROPOSED ROAD STUDS
	PROPOSED ASPHALT CARRIAGEWAY SURFACING. DETAILS TBC
	DESIGN FEATURE - REFERENCE

REFERENCE	DESIGN FEATURES
DF/01	PROPOSED MAINTENANCE LAY-BY
DF/02	PROPOSED NCNS NORTHERN LINK TO A40 SHARED PATH
DF/03	NCNS SOUTHERN LINK OPTIONS - TO BE FURTHER ASSESSED IN PRELIMINARY DESIGN.